

FEDERAL WAY HIGH SCHOOL PARKING

- STUDENT/STAFF
- STUDENT/VISITOR
- STAFF

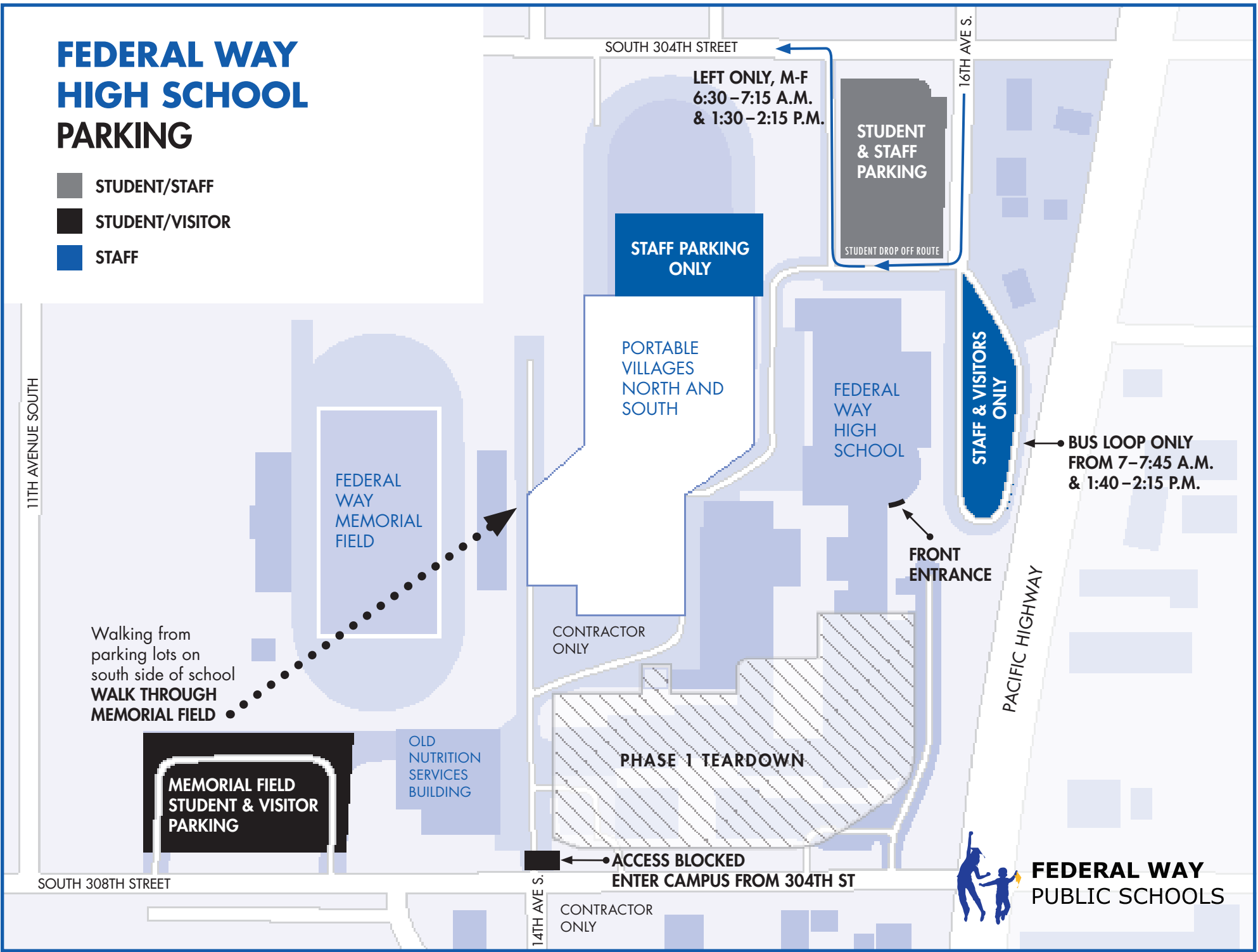

LEFT ONLY, M-F
6:30 – 7:15 A.M.
& 1:30 – 2:15 P.M.

STUDENT
& STAFF
PARKING

STAFF PARKING
ONLY

STUDENT DROP OFF ROUTE

PORTABLE
VILLAGES
NORTH AND
SOUTH

FEDERAL
WAY
HIGH
SCHOOL

STAFF & VISITORS
ONLY

BUS LOOP ONLY
FROM 7 – 7:45 A.M.
& 1:40 – 2:15 P.M.

FRONT
ENTRANCE

CONTRACTOR
ONLY

PHASE 1 TEARDOWN

OLD
NUTRITION
SERVICES
BUILDING

MEMORIAL FIELD
STUDENT & VISITOR
PARKING

Walking from
parking lots on
south side of school
**WALK THROUGH
MEMORIAL FIELD**

ACCESS BLOCKED
ENTER CAMPUS FROM 304TH ST

CONTRACTOR
ONLY

FEDERAL WAY
PUBLIC SCHOOLS



11TH AVENUE SOUTH

SOUTH 308TH STREET

SOUTH 304TH STREET

16TH AVE S.

14TH AVE S.

PACIFIC HIGHWAY

FEDERAL WAY HIGH SCHOOL

Suggested routes to/from and around campus during peak hours:

6:45–7:45 a.m.
& **1:45–2:30 p.m.**

Note:

The construction traffic zone on 308th could be congested at any time during the workday due to oversize material deliveries.

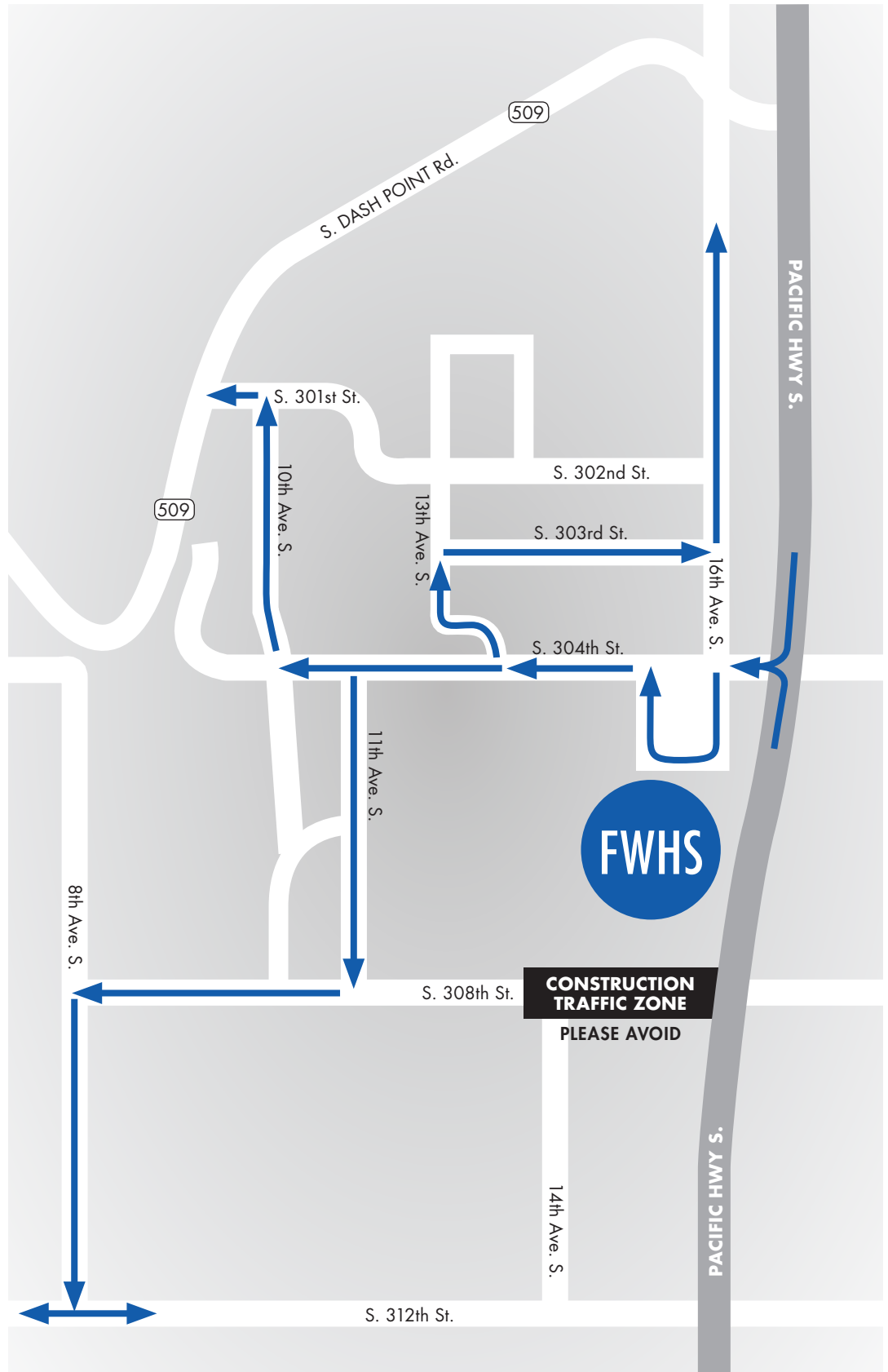

FEDERAL WAY
PUBLIC SCHOOLS